

# QC Nozzle Multiple type

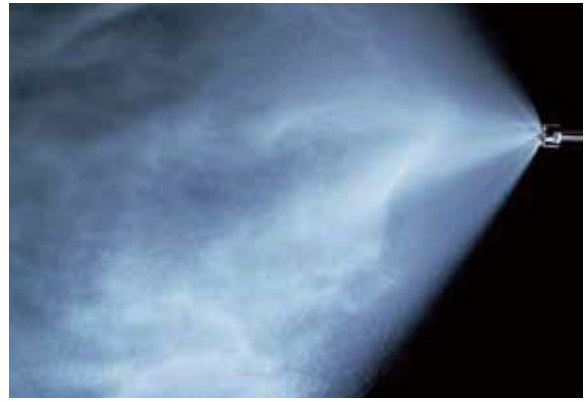
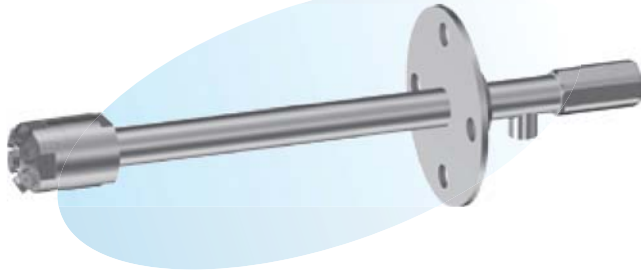

### ► Features

- Spray flow rate can be controlled within the range of 10 : 1 by controlling return pressure with the constant supply pressure.
- Wide spray angle (180° max.) achieved by using a multiple (3, 4, 6, or 7) nozzle tip.
- The lower spray flow rate, the smaller droplets, with the constant supply pressure.

### ► Applications

- Cooling of gases, washing, humidity control, etc.

### ► Material

- Principal parts : 316 Stainless steel  
Other materials available upon request.

### Shapes and dimensions

#### ● KSWC ... - 6QC type

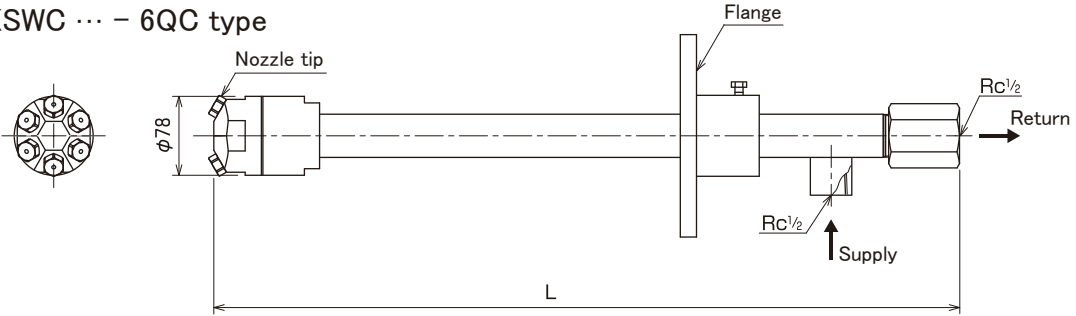

\* NPT thread is also available.

※ Dimension L and flange size are to be specified by the customer.

#### ● Model and Model Number representing

K S W C 0 4 5 - 6 Q C  
 Model number      Number of nozzle tips

### ● Performance data

#### Characteristic curves

Nozzle model number    KSWC 035 - 6 QC

- Supply pressure : 2.0 MPa
- Supply pressure : 1.5 MPa

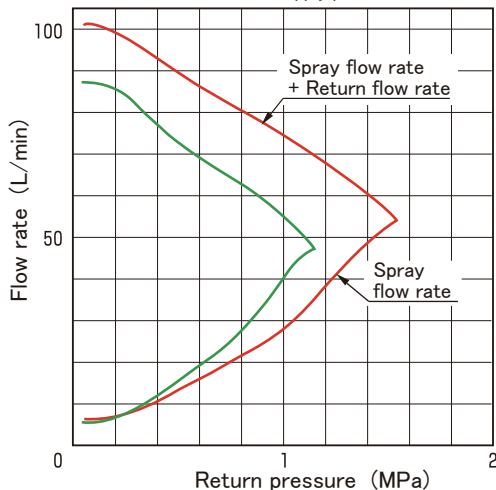

#### Characteristic curves

Nozzle model number    KSWC 05 - 6 QC

- Supply pressure : 3.0 MPa
- Supply pressure : 2.5 MPa

